

Framing and matting a 9.5 x 14 print

- STEP 1: Buy a ready made frame with glass that has an opening of 16 X 20 inches.
Buy a frame without a matt, because you will need to either cut a matt, or have someone cut a matt for you.
- STEP 2: Pick out a matt color that goes with the print and your home decor if possible.
It is more important to choose a color that goes well with the print.
- STEP 3: Either cut or have the matt cut as shown below.

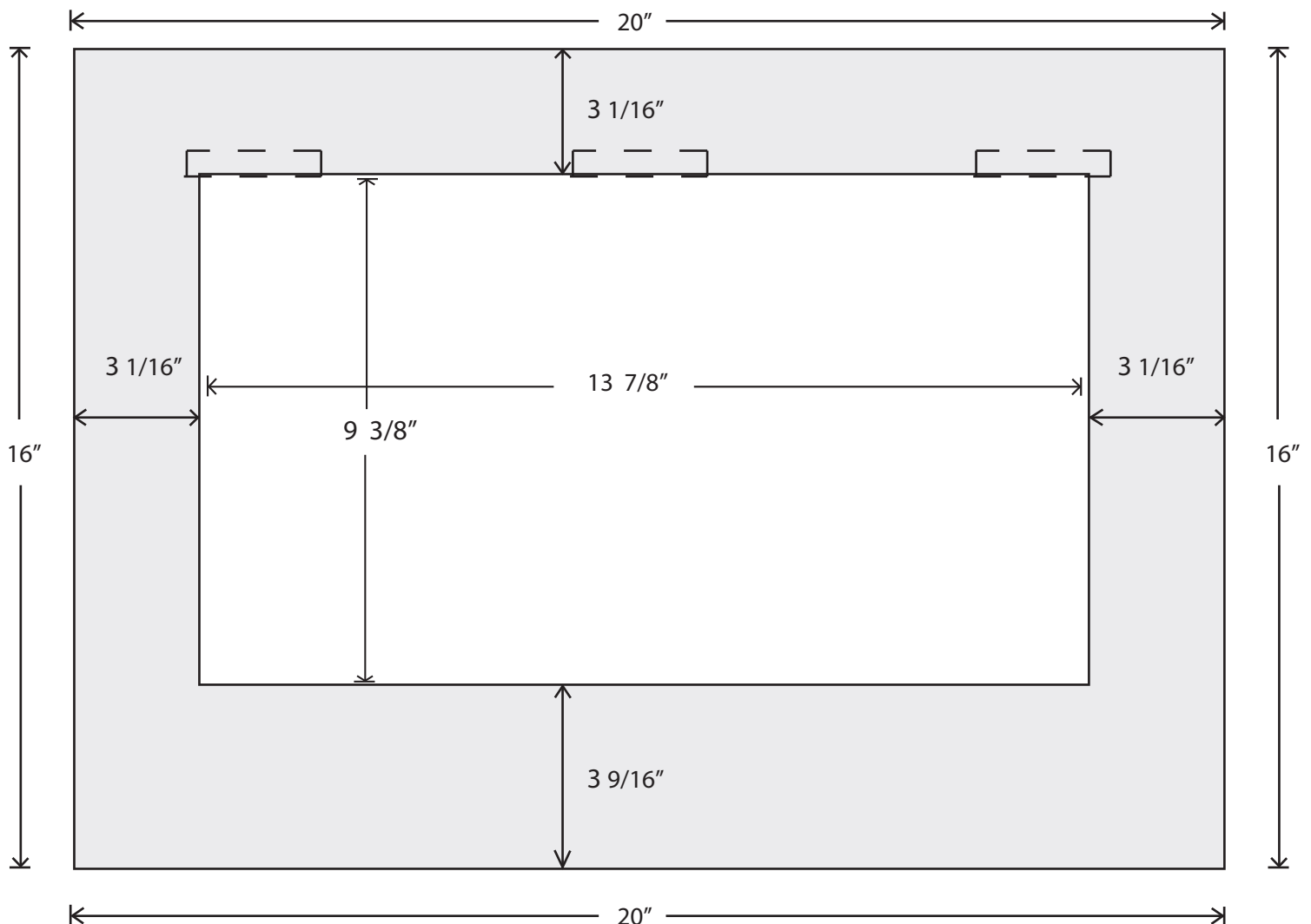

- STEP 4. With clean hands, using double sided tape, tape the print to the matt in three places (as shown by the dotted lines) in the following way:
- lay the print face up on a table
 - tear off small peices of tape and adhere the first side to the print on the white border at the top left, middle, and right of the print (as shown)
 - Carefully hold the matt over the print to position it so that none of the white border around the print is showing
 - Once you have the matt positioned correctly, apply pressure to the taped areas to secure it
- STEP 5. Place the matt in the frame and hang on the wall to enjoy.

If you have questions, call 720-898-9798 or email mark@dottarts.com